

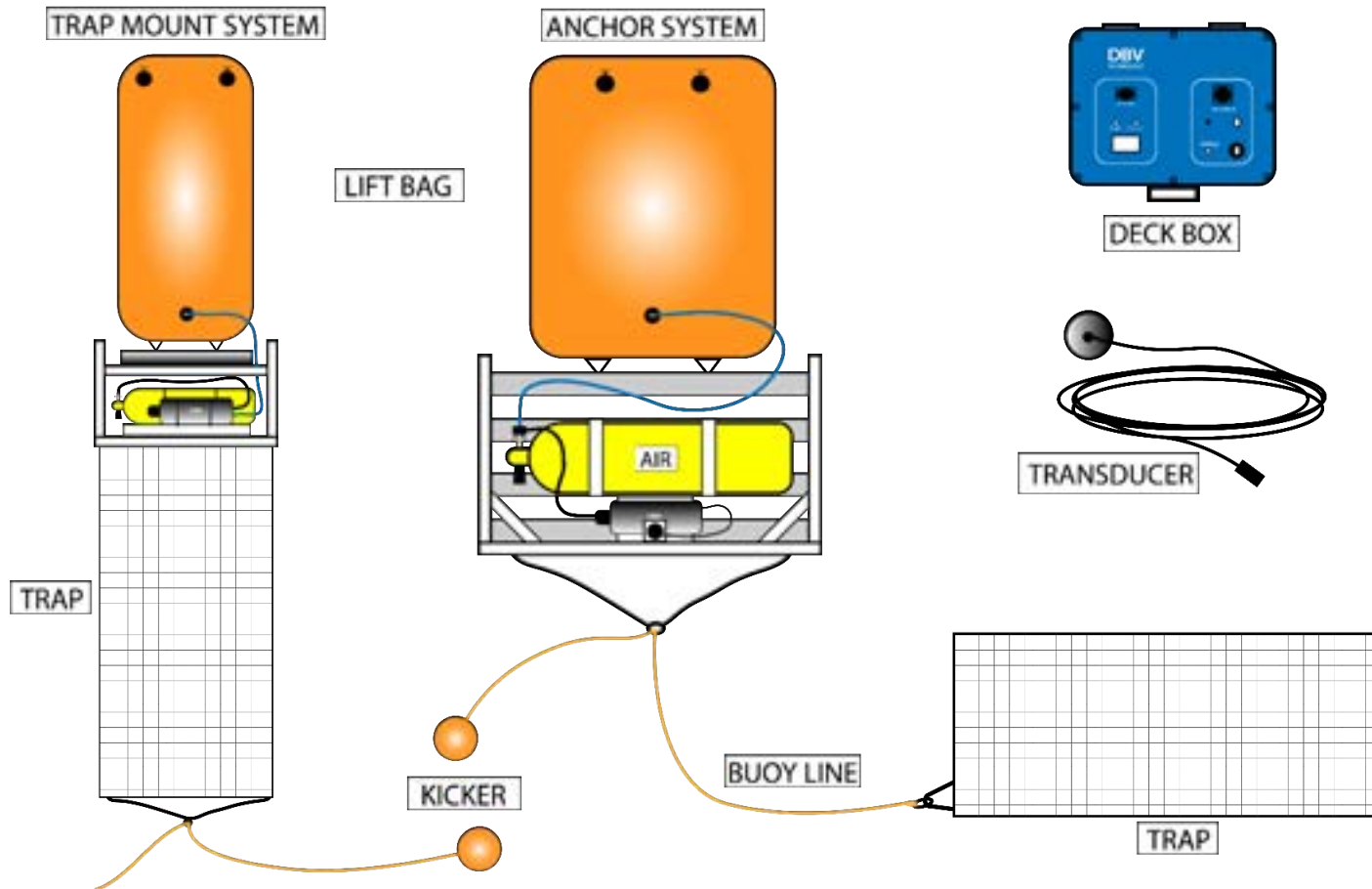

ROPELESS[™]
SYSTEMS

Ropeless RISER Setup





- **Attach the unit** to your trawl by connecting the bridle on the unit to the end of your groundline.
- Ensure the length of rope between your last trap and your unit is the same as the length between traps.

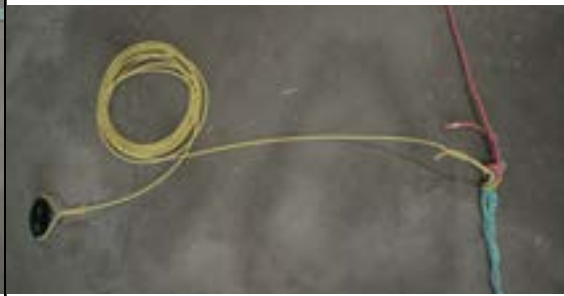

- Attach a (max. 3 fa) **pick line** with a small buoy to the bridle of the unit.

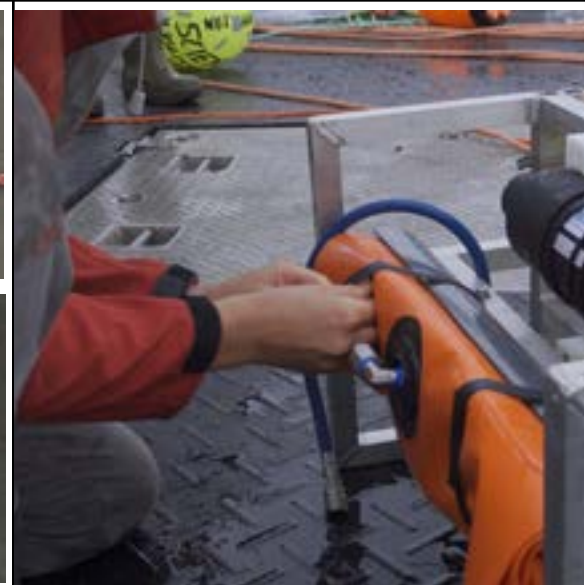

- **Roll the bag up** and use the Velcro strap to hold it in place.
- When the bag is rolled up, the valve should be on the outside.



- Ensure the **oxygen tank is connected to the lift bag** via the blue (high pressure) air hose.
- Ensure the **oxygen tank has been filled** with enough air to raise your gear when deployed.

- Make sure the black/red shorting plug is connected to the Actuator (black cylinder beside the scuba tank).
- **Take note of the code** on the black cylinder, you need this to recover the unit. It should be in the format XX-XX-XX.

- **Open the scuba valve** on the tank before deployment, otherwise the unit will not surface.
- **Deploy the unit** by pushing it over with your trawl when you are at the desired location.



- **Assemble the Deck Box** by plugging in the transducer into the deck box and turning it on.
- Connect the coiled audio cable from the deck box to the tablet.
- Ensure the battery voltage on the deck box reads at least 24V.
- Ensure the volume on the tablet is turned all the way up.



- **Recover** the unit by lowering the transducer into the water 6 feet below the hull.
- Send the signal from the stern of the boat on the side closest to the unit to minimize noise interference.



- **Open the RISER app on the tablet and enter the release code** for the unit you want to recover, then press PLAY.
- **Select “loop”** to continue signaling until the ropeless riser unit surfaces.



- When the unit surfaces, **gaff it by the pick line/kicker.**
- **Haul** the unit onboard, followed by the groundline and the rest of the trawl.

- **Close the scuba valve** as soon as the unit is on board to minimize air loss.
- **Reset** the device by disconnecting the blue (high pressure) air hose and pulling the black pressure release valves on the bag to deflate it.

- Once completely deflated, **roll the lift bag back up** and attach it with the Velcro strap.
- Reconnect the blue high pressure air hose.



- **To Refill an Empty Tank**, first ensure the valve is closed, then remove the empty tank from the unit.



- Connect the empty tank to a gray refill tank with the black two-headed hose, making sure the pressure gauge is on the full gray refill tank.
- Open the empty tank valve. The pressure of the empty tank will be shown on the pressure gauge. Very slowly open the full tank valve, keeping a hand on the empty tank to make sure it does not overheat.



- Increase the flow rate as needed by opening the valve more.
- Stop when desired pressure is reached.
- Close the valve on the refill tank, and then the valve on the newly filled tank.
- Finally, open the pressure valve underneath the pressure gauge before disconnecting the tanks.
- Re-attach the filled tank to the unit.

Troubleshooting Ropeless RISER

PROBLEM	POSSIBLE CAUSES	PREVENTION AND POSSIBLE SOLUTIONS
The transducer does not make any sound	The volume level is set too low	Turn the volume up on the tablet using the button on the side
The system released but the bag did not inflate	The scuba valve was not opened before deployment	Always ensure the scuba valve is open before deploying the unit
The system did not surface	The incorrect release code was entered in the RISER app on the tablet.	Check that the correct release code is being used for the unit you wish to recover. Reposition the vessel and try signaling again.



canFISH
GEAR LENDING PROGRAM

PROGRAMME DE PRÊT D'ENGINS
innovPÊCHE